



California Faucets®

D Street™

WALL TUB SPOUT

Features

- Available in 28 finishes including 13 PVD finishes
- All brass construction
- Includes decorative base ring
- Maximum flow rate: 16 gpm (60.6 L/m) at 60 psi
- For use with: StyleTherm, 3-VR or 2-VR

TS-52-52
D-52-52
DE-52-52

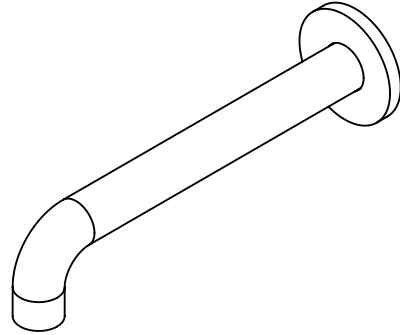

Codes/Standards Applicable

Product meets or exceeds the following:

- ASME A112.18.1/CSA B125.1

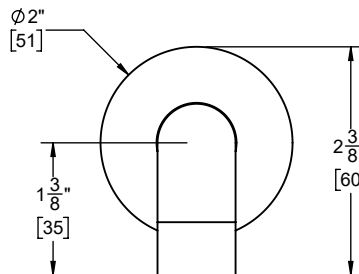
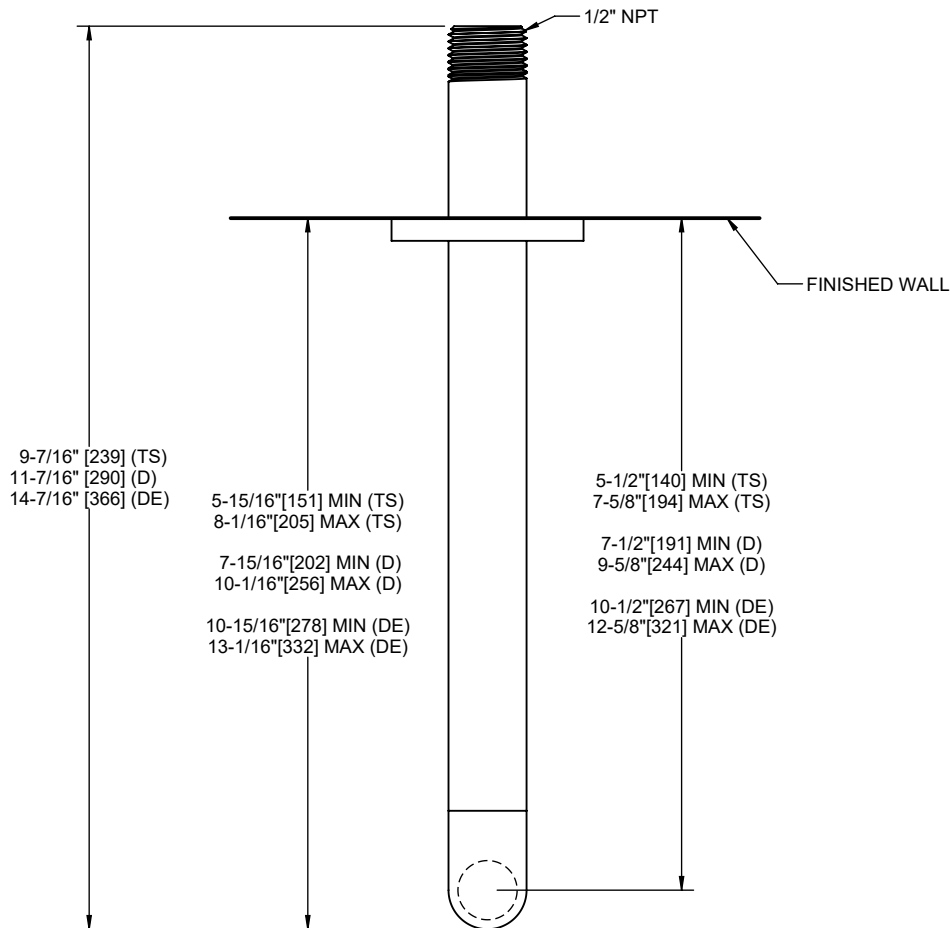

THROUGH-HOLE SPECIFICATIONS		
MIN	RECOMMENDED	MAX
SPOUT: Ø 15/16" [24]	Ø 1-1/4" [32]	Ø 1-5/8" [41]

DIMENSIONS SHOWN TO NEAREST 1/16"
[DIMENSIONS SHOWN TO NEAREST 1MM]

SPECIFICATIONS SUBJECT TO CHANGE WITHOUT NOTICE